

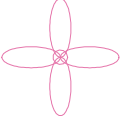









NOTE :-

THIS DRAWING IS COPYRIGHT AND MUST NOT BE USED OR COPIED WITHOUT PRIOR AUTHORISATION FROM B & J BUILDING

ELECTRICAL LEGEND :-

-  CEILING SWEEP FAN. 1200mm.
-  1X18W FLUORESCENT LIGHT FITTING DIFFUSED.
-  2X36W FLUORESCENT LIGHT FITTING DIFFUSED.
-  1X120 FLUORESCENT LIGHT FITTING
-  DOUBLE G.P.O.
-  SINGLE 15 Amp G.P.O.
-  SWITCH RUN
-  AIR CONDITIONER
-  WALL EXHAUST FAN
-  SMOKE⊕ SMOKE DETECTOR

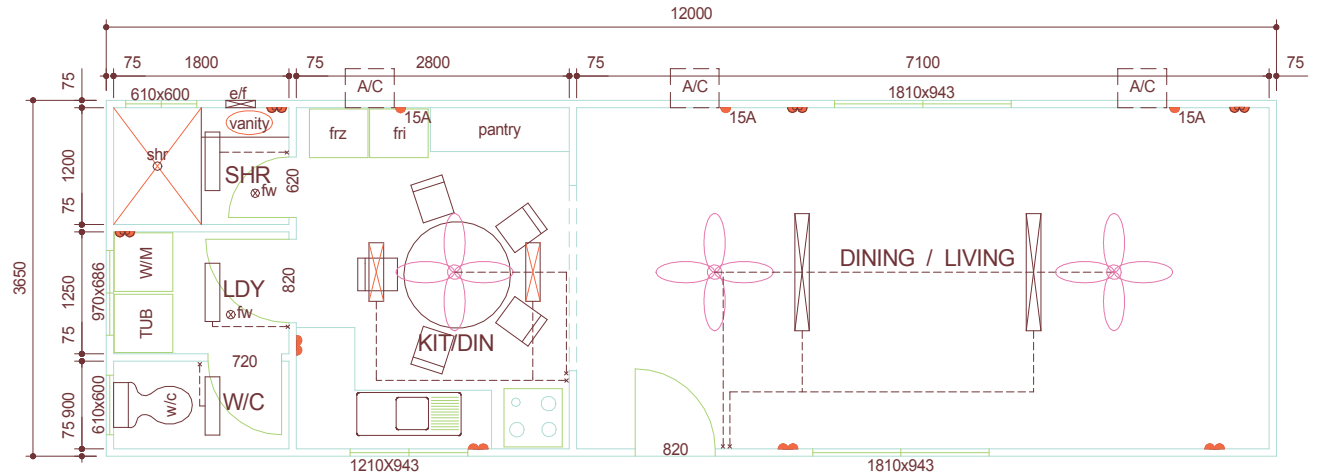

FLOOR PLAN

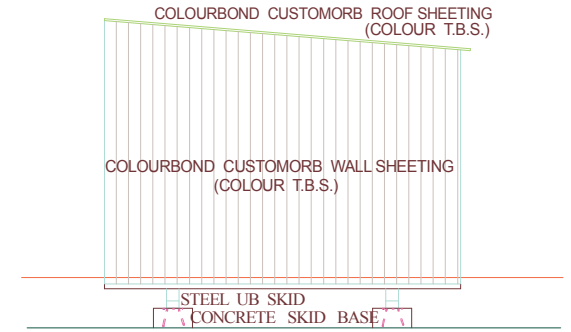

END ELEVATION



B & J BUILDING CONSULTANTS & STEEL SUPPLIES
 PHONE :- 91926262 - 91926263 FAX :- 91926264
 Lot 50, Port Drive, Broome.
 P.O. Box 1308, Broome. W.A. 6725

JOB TYPE
 CHECKED
 TRADESMAN
 DATE

CLIENT:- SALES DEPT.
 ADDRESS:- AS DIRECTED.
 DESCRIPTION:- MESSING CRIB / ROOM FACILITIES THE BALGO.

SCALE 1- 50
 DRAWN PHIL
 JOB NO XX
 DWG NO XX
 DATE X